

PLASTICO  
METAVISUAL

METAVISUALE  
P L A S T I C M O D E L

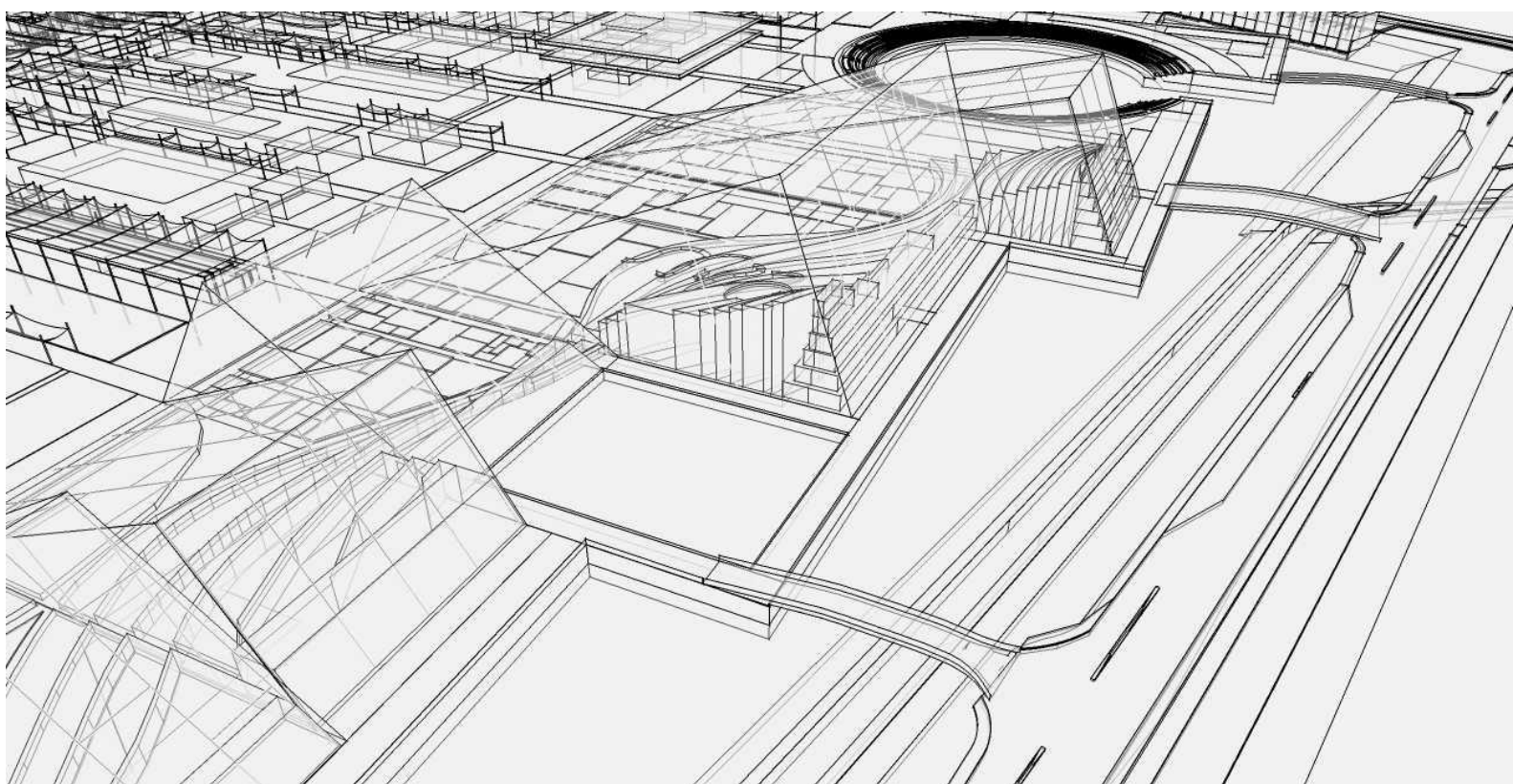

EVERYTHING IS ILLUMINATED (J.S. Foer)

REA n. MI-2023307 - P.IVA IT08399040966 - piazza Arcole, 4 - 20143 - MILANO - [www.plasticometavisuale.it](http://www.plasticometavisuale.it)

[FirstContact@plasticometavisuale.it](mailto:FirstContact@plasticometavisuale.it) - tel. +39.02.64089295

---

PLASTICO METAVISUAL METAVISUALE  
P L A S T I C M O D E L

---

The Metavisual Plastic Model is the futuristic tool to make emotional storytelling and to offer, at a glance, a compelling overview and evolution of all sort of projects.

Small and large infrastructures, archaeological sites, urban settlements, scientific or technological plans, cities, territories, entire Countries: this innovative technology can be used for many possible applications.

Built from a virtual model in the panoramic size of about 4.5 to 7 meters, the Metavisual Plastic Model tells the history, the present time and the future of places and communities of people.

Strategies, themes, values of each project are shown on Metavisual Plastic Model using images, high resolution orthophotos, infographics, subtitles, data and video.

No need to put on polarized glasses: 3D is real and it is created in front of the spectators when the Metavisual Plastic Model is activated.

Its white and modeled surface is illuminated with light

EVERYTHING IS ILLUMINATED (J.S. Foer)

REA n. MI-2023307 - P.IVA IT08399040966 - piazza Arcole, 4 - 20143 - MILANO - [www.plasticometavisuale.it](http://www.plasticometavisuale.it)

[FirstContact@plasticometavisuale.it](mailto:FirstContact@plasticometavisuale.it) - tel. +39.02.64089295

and a changeable electronic fabric.

A soundtrack and a voice-over start the story, accompanied by spectacular video sequences, to shape the forms that appear as flown over the air.

The storytelling promotes an immediate and fascinating understanding of the content, by citizens, investors, tourists and, in general, stakeholders.

A digital sky can complete the installation, creating an unprecedented immersive environment.

The Metavisual Plastic Model has its ideal location in permanent venues, but can also be transported worldwide on tour, within temporary tensile structures.

Discover the Metavisual Plastic Model, let your public live a fascinating experience: future is now.

Contact us to consider our technology in your communication projects: visit [www.metavisuale.it](http://www.metavisuale.it), start a chat with us or write us an e-mail on [firstcontact@plasticometavisuale.it](mailto:firstcontact@plasticometavisuale.it). You can phone, too, at +39.02.64089295.

EVERYTHING IS ILLUMINATED (J.S. Foer)

REA n. MI-2023307 – P.IVA IT08399040966 – piazza Arcole, 4 - 20143 - MILANO – [www.plasticometavisuale.it](http://www.plasticometavisuale.it)

[FirstContact@plasticometavisuale.it](mailto:FirstContact@plasticometavisuale.it) – tel. +39.02.64089295